



ES850NB

Wireless Noise Cancelling Over-Ear Headphones

Model: EDF280044

Manual

BC

EN 1. Power ON/OFF

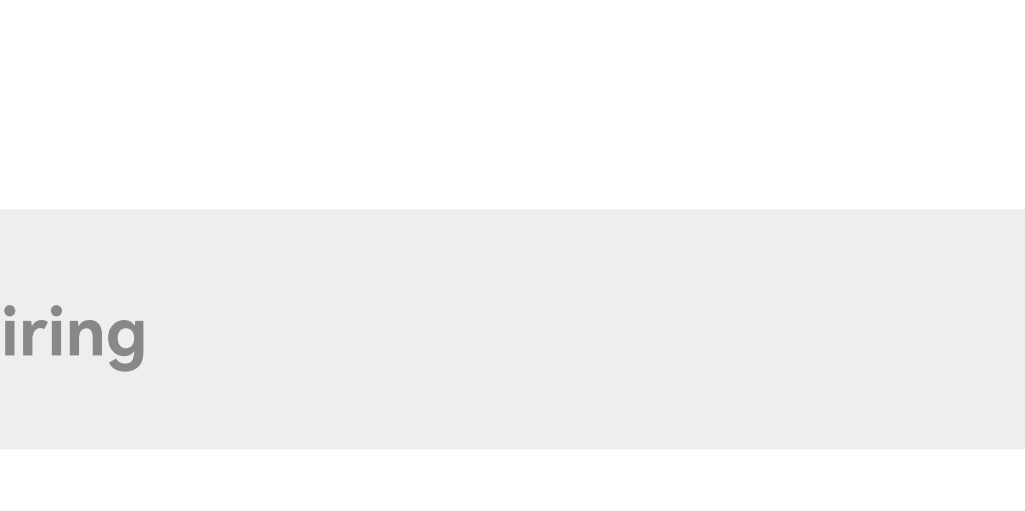

Press and hold the power button to power on/off.

2. First pairing

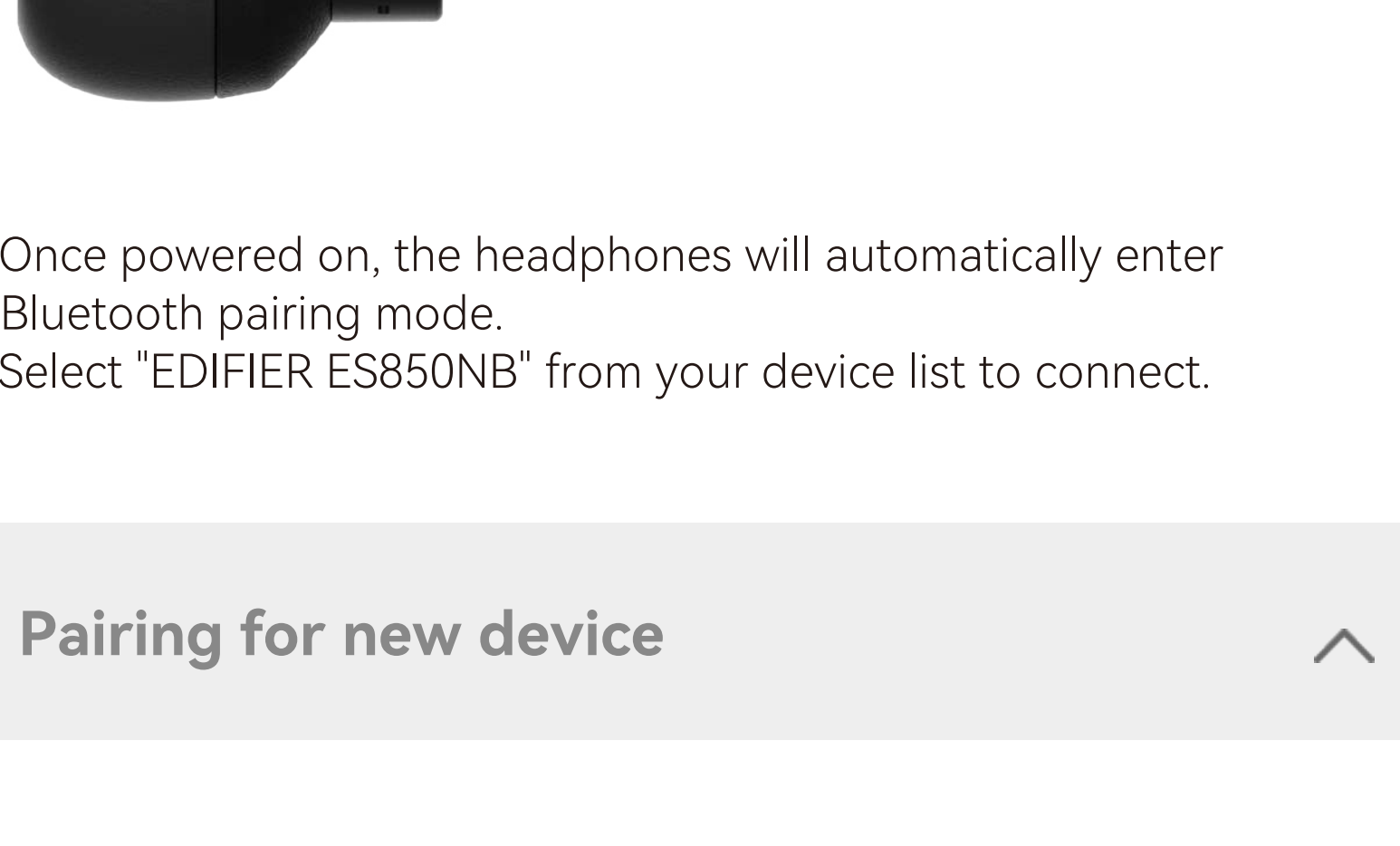

- Once powered on, the headphones will automatically enter Bluetooth pairing mode.
- Select "EDIFIER ES850NB" from your device list to connect.

3. Pairing for new device

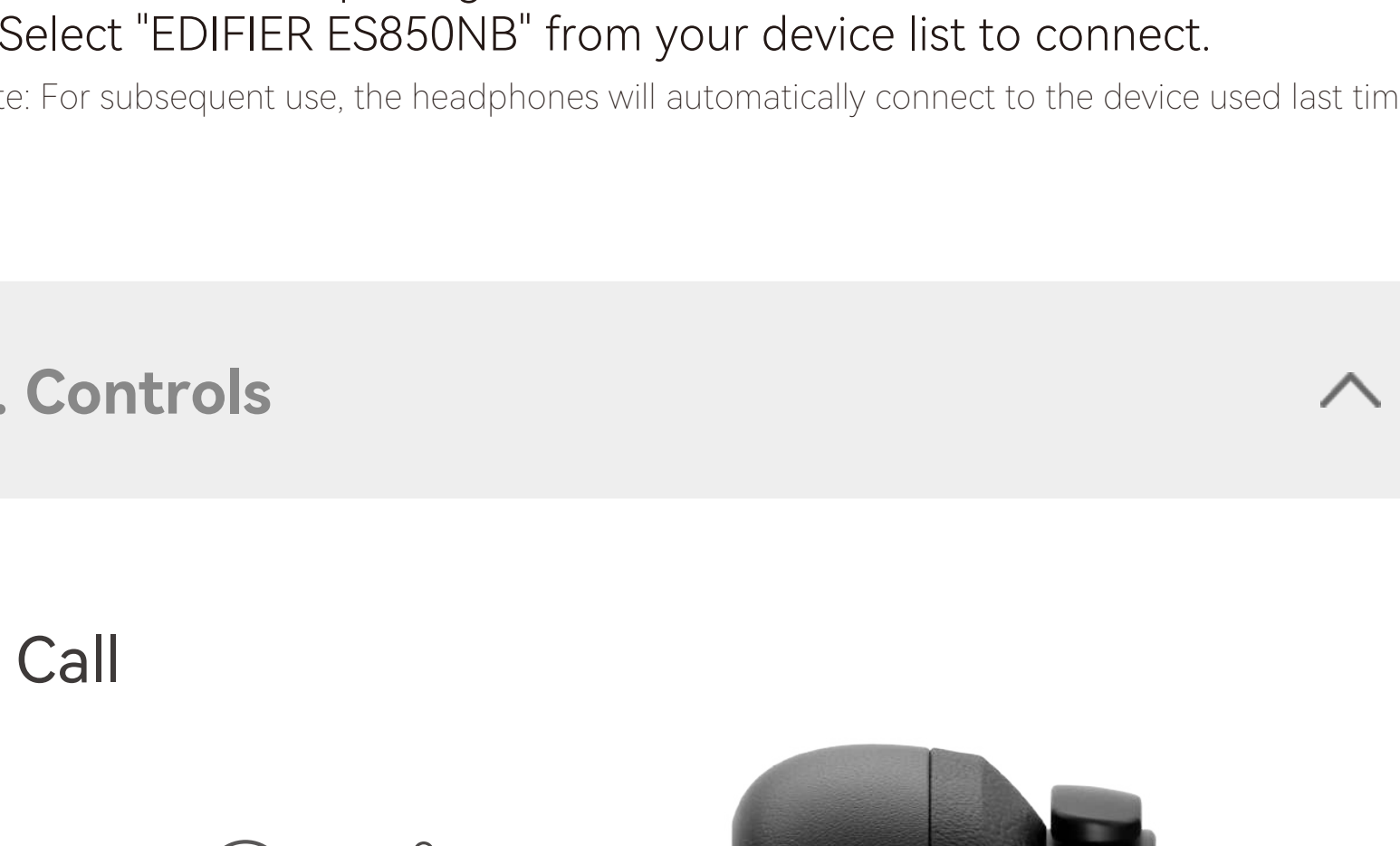

- In ON state, press and hold the "Bluetooth" button for about 3 seconds to enter Bluetooth pairing mode.
- Select "EDIFIER ES850NB" from your device list to connect.

Note: For subsequent use, the headphones will automatically connect to the device used last time.

4. Controls

• Call



• Music

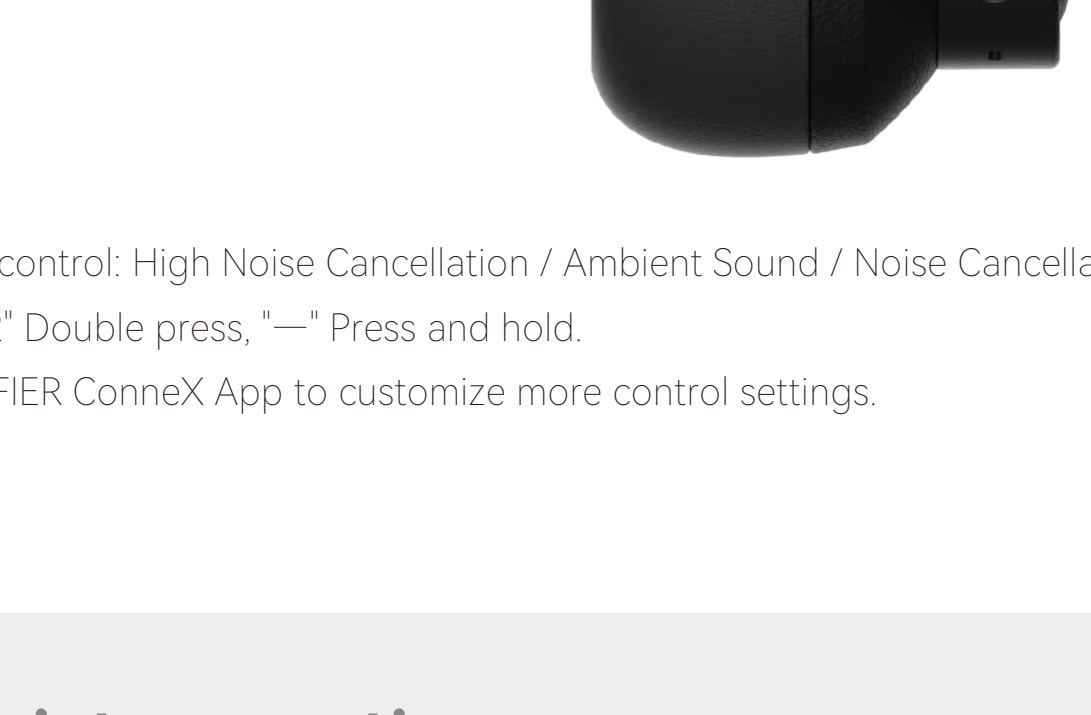

• Mode

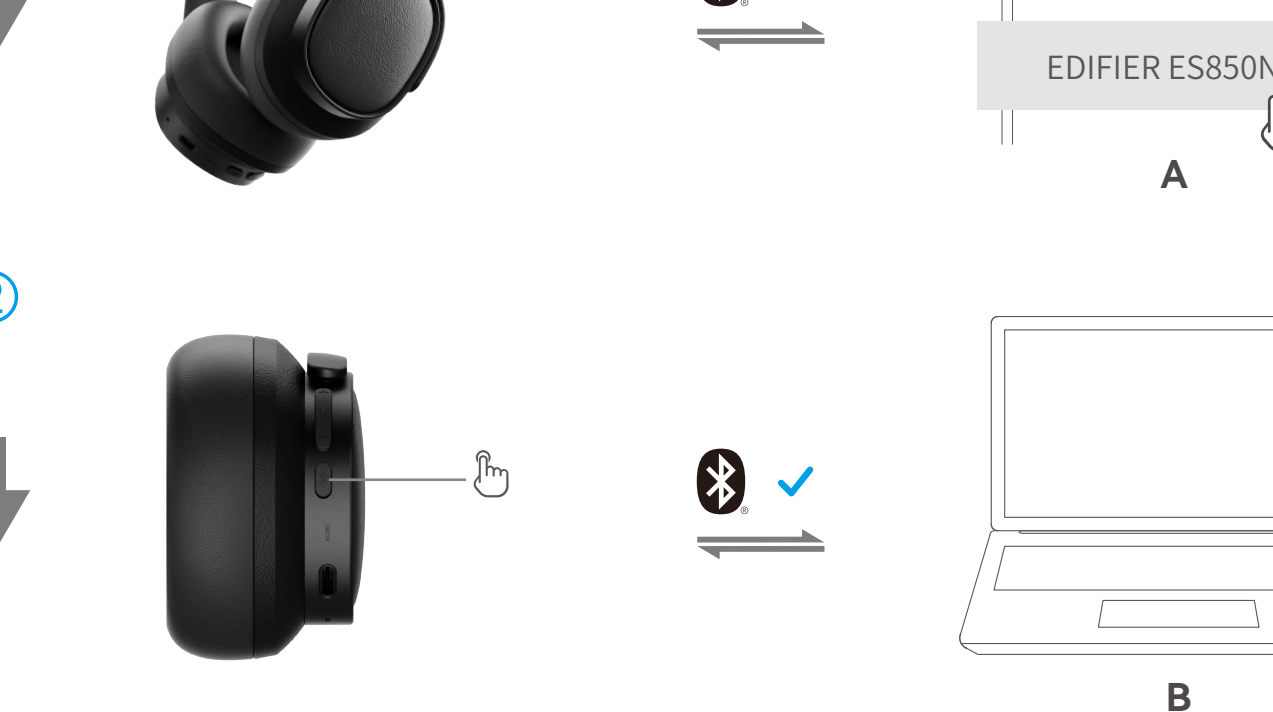

Note:

1. Default sound control: High Noise Cancellation / Ambient Sound / Noise Cancellation Off.

2. "x1" Press, "x2" Double press, "-" Press and hold.

3. Download EDIFIER ConneX App to customize more control settings.

5. Multipoint connection

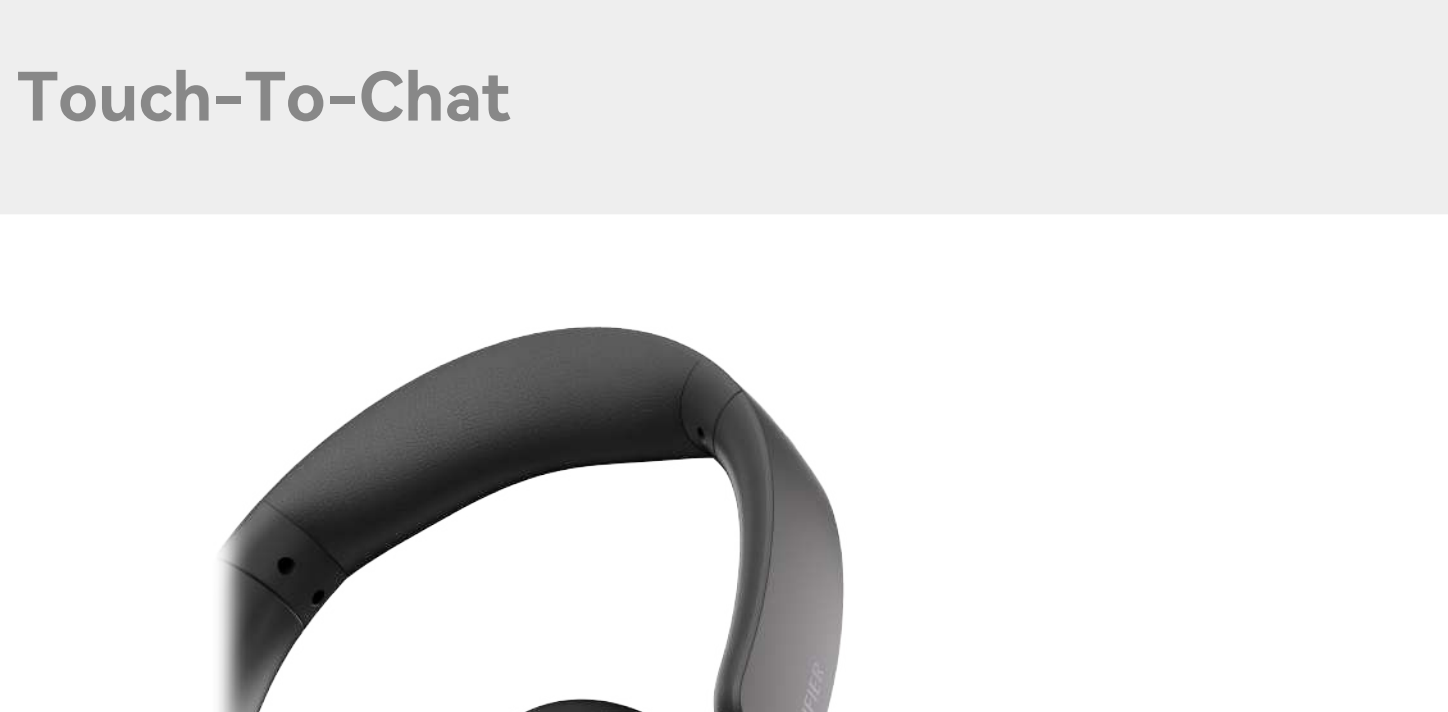

- Pair device A with the headphones successfully.
- Press and hold the "Bluetooth" button for 3 seconds to re-enter Bluetooth pairing mode, and then select "EDIFIER ES850NB" in device B settings to connect.
- Select "EDIFIER ES850NB" again in device A settings to complete the multipoint connection.

Note: For subsequent use, the headphones will automatically reconnect to the two devices used last time.

6. Touch-To-Chat



Touch and hold the right earcup to pause audio and allow you to hear ambient sound, release to resume audio.

7. Wired listening



Connect to the headphones via the USB-C cable. Wired listening will automatically disable Bluetooth mode.

8. Reset

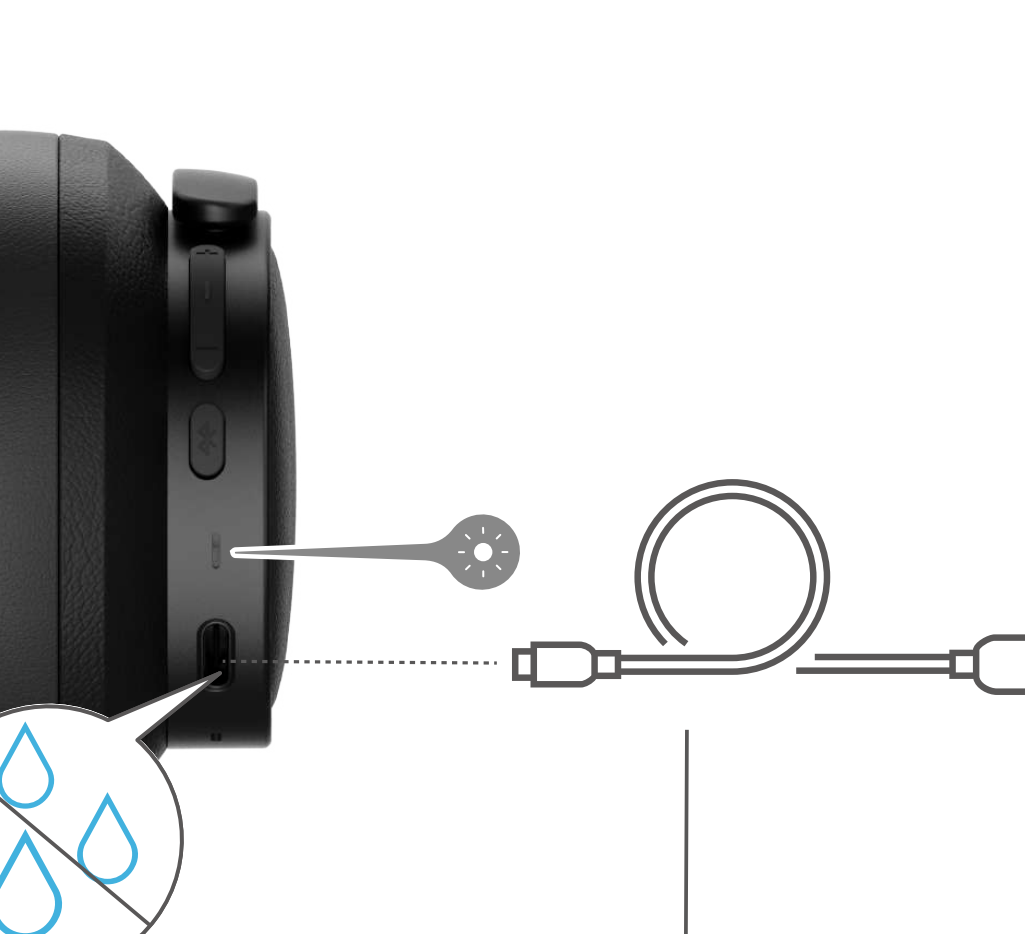

- In ON state, press "+" and "-" buttons for 5 seconds, blue LED will blink until the reset is complete.
- Then the headphones will automatically enter Bluetooth pairing mode.

9. Charging

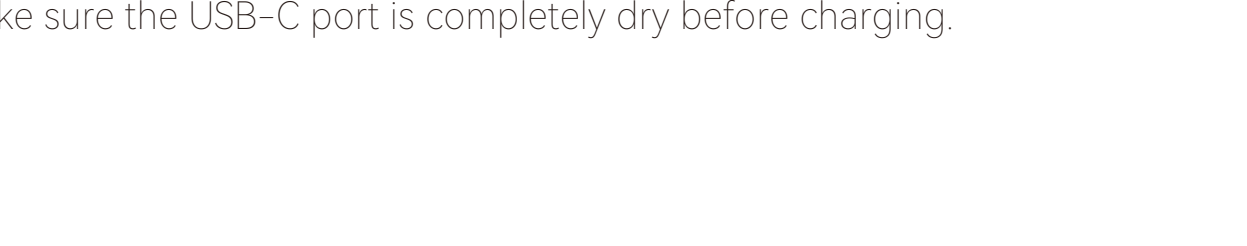

Connect the headphones to a power source via the USB-C cable for charging.

Note: Make sure the USB-C port is completely dry before charging.